

E-line – Series of Standard Electric Door Strikes

TECHNICAL DETAILS

Break-in resistance:
3,500 N (356kg)

Body material:
zinc – die casting

Keeper material:
zinc – die casting, brass

Operating temperature range:
-15°C – +40°C

Certification:
EN 12209 – Class 2
P ENV 1627 – Class 2



E-line – Series of standard electric door strikes

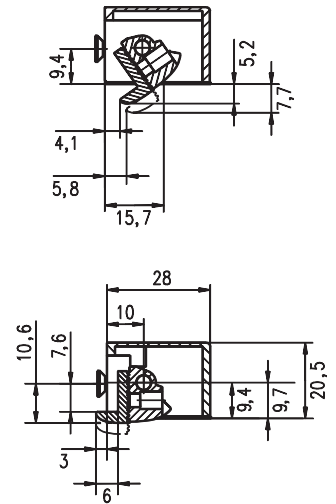
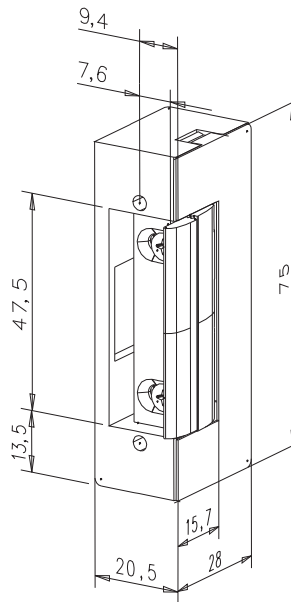

Application

- Universal door strikes.
- Symmetrical design.
- FaFix (adjustable keeper) as a standard item.
- Fully reversible for both right-hand and left-hand DIN doors when turned by 180 degrees.
- Can be used with any common striking plate.

Strike Versions

- **Open when power is applied, blocked when power is disconnected** Designation: E7 Coils: D1, E4, F4
- **Open when power is applied, blocked when power is disconnected + mechanical release** Series: E7E Coils: D1, E4, F4
- **With release for a single passing on electric pulse** Series: E7A Coils: D1, E4, F4
- **Blocked when power is applied, open when power is disconnected (reversed strike)** Series: E7R Coils: E9, F9

Electrical Specifications

Note:
The E-line strikes can't be used in fire resistant doors due to used materials not meeting the specifications for thermal resistance (to 1,000°C) required for fire resistant doors.

Type	Description	Supply voltage (V)	Coil resistance (Ohm)	Current consumption AC (mA)	Current consumption DC (mA)
E7-D1	Strike 6 – 12 V AC/DC	6 – 12 V AC/DC (12V operation)	9.1	1,100/5 sec	1,300/5 sec
E7-E4	Low consumption strike 12 V DC	12 V DC	44	–	270
E7-F4	Low consumption strike 24 V DC	24 V DC	200	–	120
E7E-D1	Strike 6 – 12 V AC/DC with mechanical release	6 – 12 V AC/DC (12V operation)	9.1	1,100/5 sec	1,300/5 sec
E7E-E4	Low consumption strike 12 V DC with mechanical release	12 V DC	44	–	270
E7E-F4	Low consumption strike 24 V DC with mechanical release	24 V DC	200	–	120
E7A-D1	Strike 6 – 12 V AC/DC with release for a single passing	6 – 12 V AC/DC (12V operation)	9.1	1,100/5 sec	1,300/5 sec
E7A-E4	Low consumption strike 12 V DC with release for a single passing	12 V DC	44	–	270
E7A-F4	Low consumption strike 24 V DC with release for a single passing	24 V DC	200	–	120
E7R-E9	Low consumption reversed strike 12 V DC	12 V DC	51	–	235
E7R-F9	Low consumption reversed strike 24 V DC	24 V DC	160	–	150